



DIVISION SCOLAIRE

LOUIS RIEL

SCHOOL DIVISION

A Second School in Sage Creek

École Sage Creek School
French Immersion Program Families

Proposed Temporary Solution for the English Program in Sage Creek: Grades 7-8

2020-2021
2021-2022



Grade 5 and 6 English Program students living in Sage Creek attend Shamrock School

2022-2023



Grade 5, 6, 7 English Program students living in Sage Creek attend Shamrock School

2023-2024



Grade 5, 6, 7, 8 English Program students living in Sage Creek attend Shamrock



Proposed Temporary Solution for the French Immersion Program in Sage Creek: Grades 7-8

Until a new school is built



Grade 7 and 8 French Immersion program students attend Collège Béliveau

2025-2026



Kindergarten to Grade 8 French Immersion students attend new school built for 850 students

Proposed Solution: English Program Students Living in Sage Creek: Grades 9 to 12

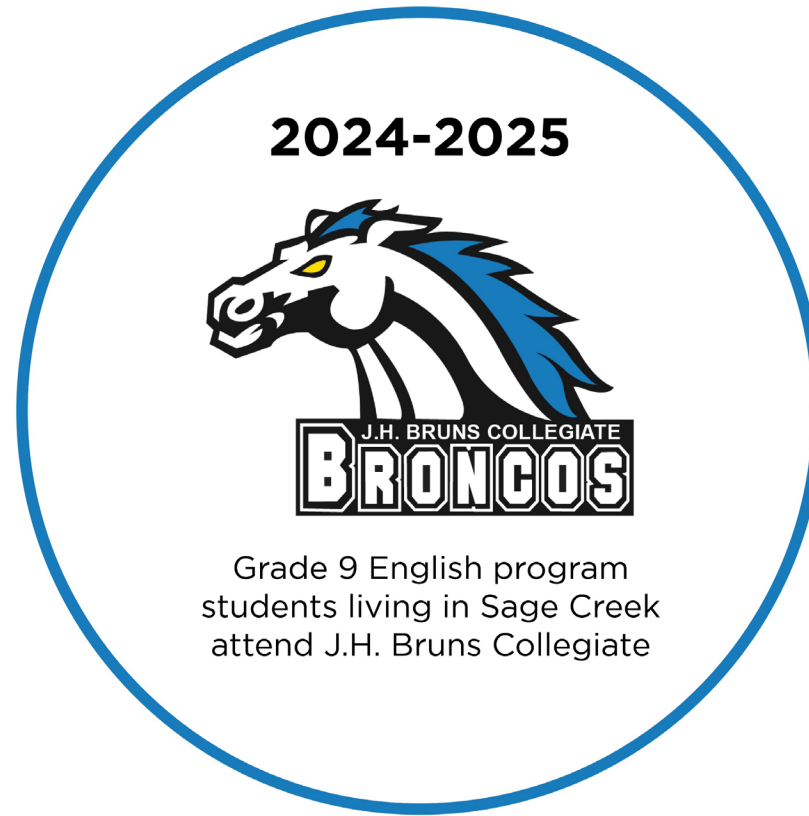



Proposed Solution: French Immersion Program Students Living in Sage Creek: Grades 9 to 12



Grade 9 French Immersion
program students living in St.
Boniface continue to attend
Collège Béliveau



Future Reality:
Two Schools in
Sage Creek by
2025-2026

English Program students (K-8) will attend the existing school built for 600 students

French Immersion Program students (K-8) will attend the existing school built for **850** students

English Program Enrolment Projection

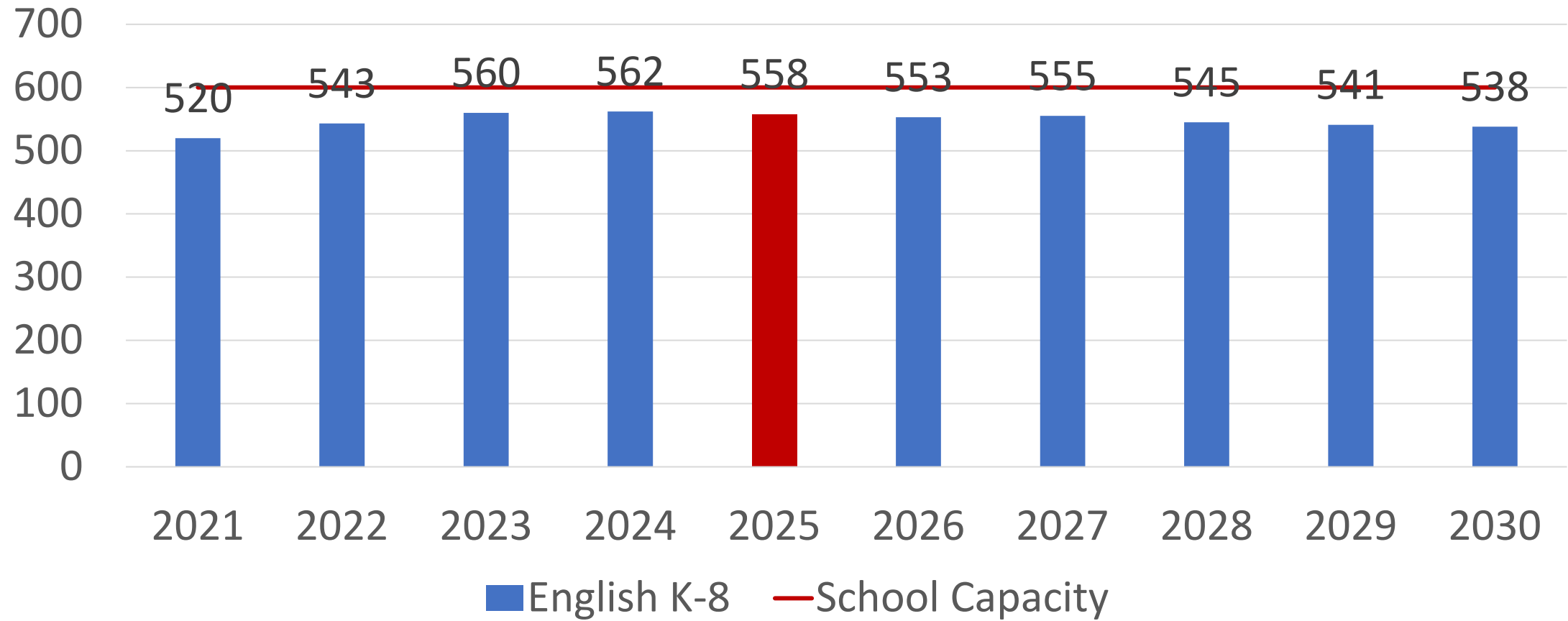



Growth of French Immersion

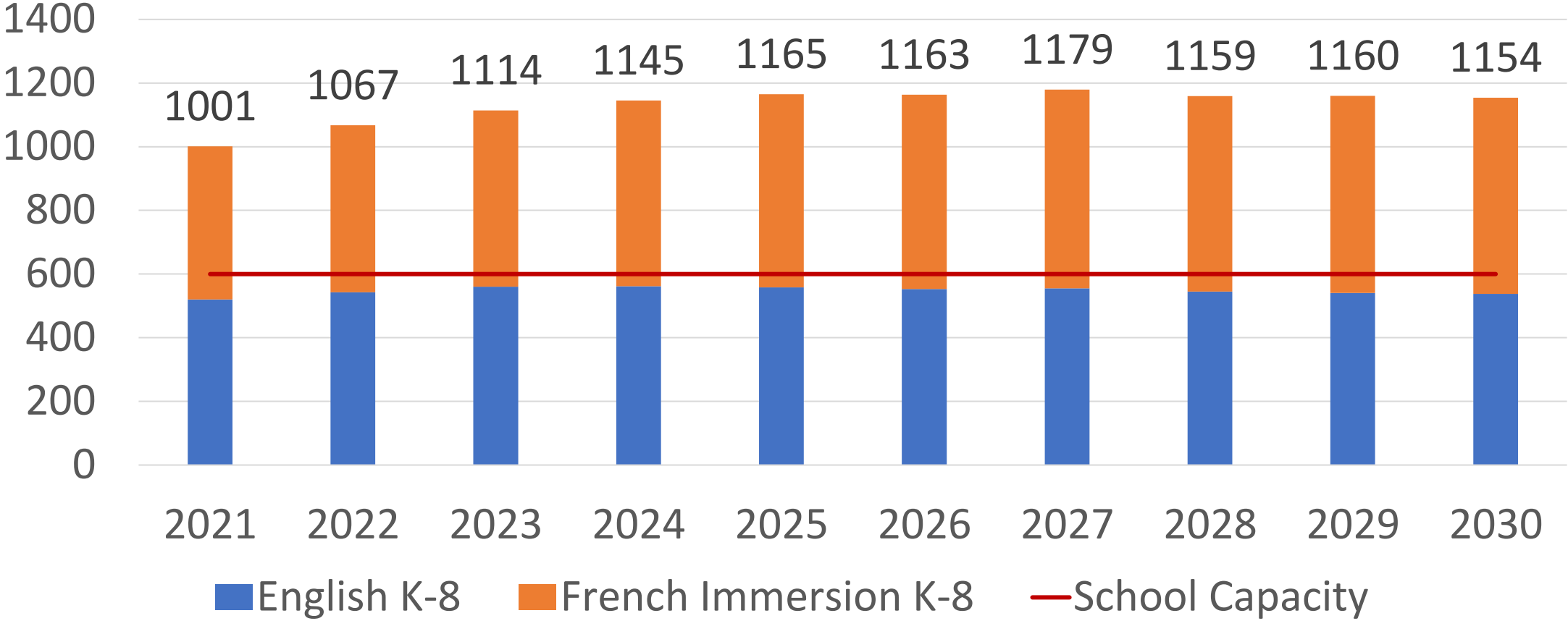



The History and Growth of French Immersion

- 1965 – St-Lambert, Quebec
- 1970 – Bill 113
- 1973 – École Sacre-Coeur (216 students)
- 1974 – Bureau de l'éducation française
- 1982 – Collège Béliveau
- 1995 – French Immersion becomes an official program
- 2003 – Manitoba: 10% (16,346 students) | LRSD 22% (3,273 students)
- 2020 – Manitoba: 15% (25,921 students) | LRSD 35% (5,228 students)



French Immersion as % of Total Enrolment (Sept. 30, 2020, Estimate, FRAME)

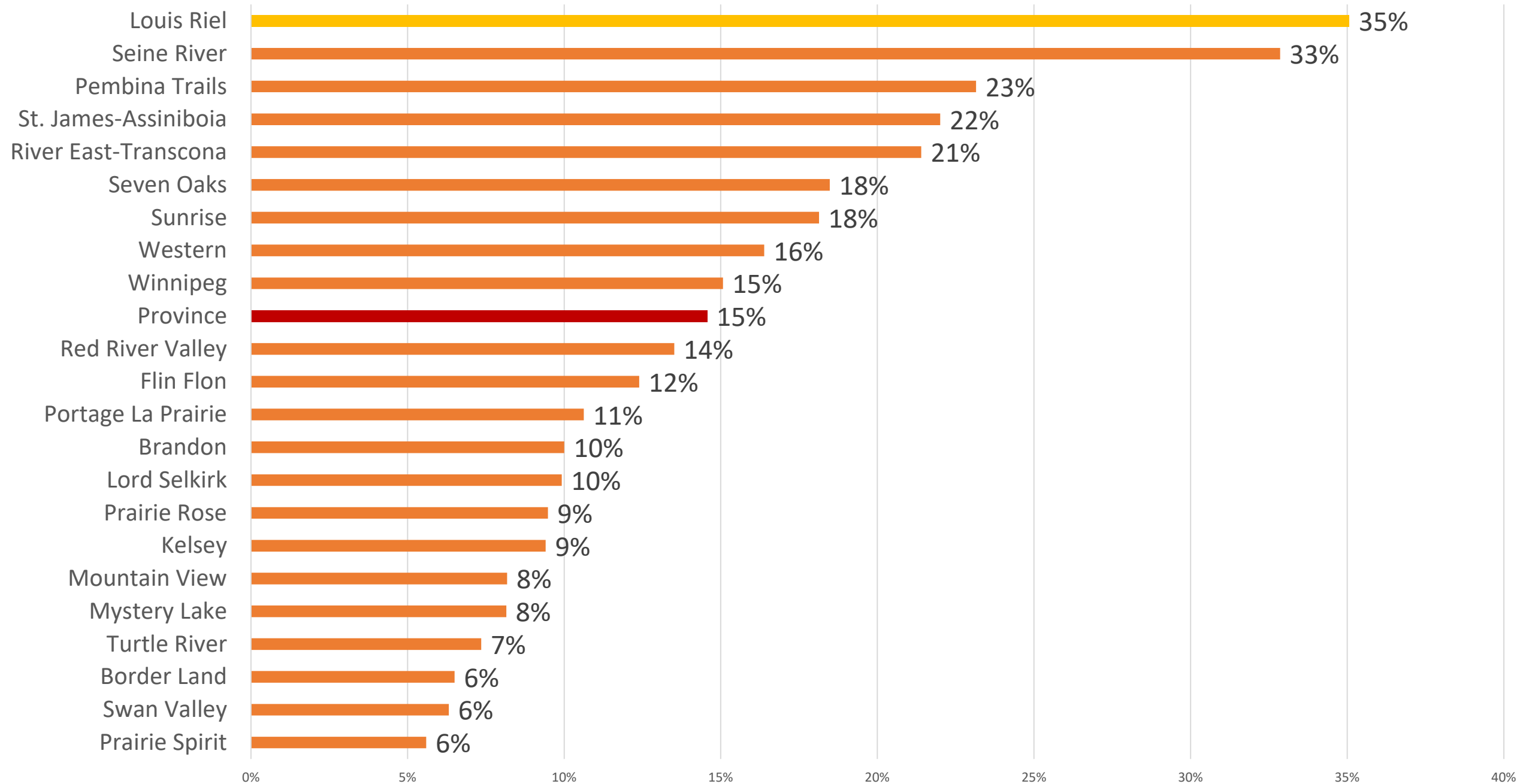



Credit Requirements for French Immersion Diploma

	Required Minimum Number of Credits from Courses Taught in French	Compulsory French Courses	Other Courses Taught in French
Grade 9	4 credits	Français langue seconde – immersion	Students must earn 10 or more credits from courses taught in French from the options available to them. Details found in the following documents: <ul style="list-style-type: none">- Graduation Requirements for the Senior Years French Immersion Program (📄 233 KB)- Other Credit Options in French Immersion (📄 139 KB)
Grade 10	4 credits	Français langue seconde – immersion	
Grade 11	3 credits	Français langue seconde – immersion : langue et communication	
Grade 12	3 credits	Français langue seconde – immersion : langue et communication	
	Minimum of 14 credits	4 credits	Minimum of 10 credits

French Immersion Projection

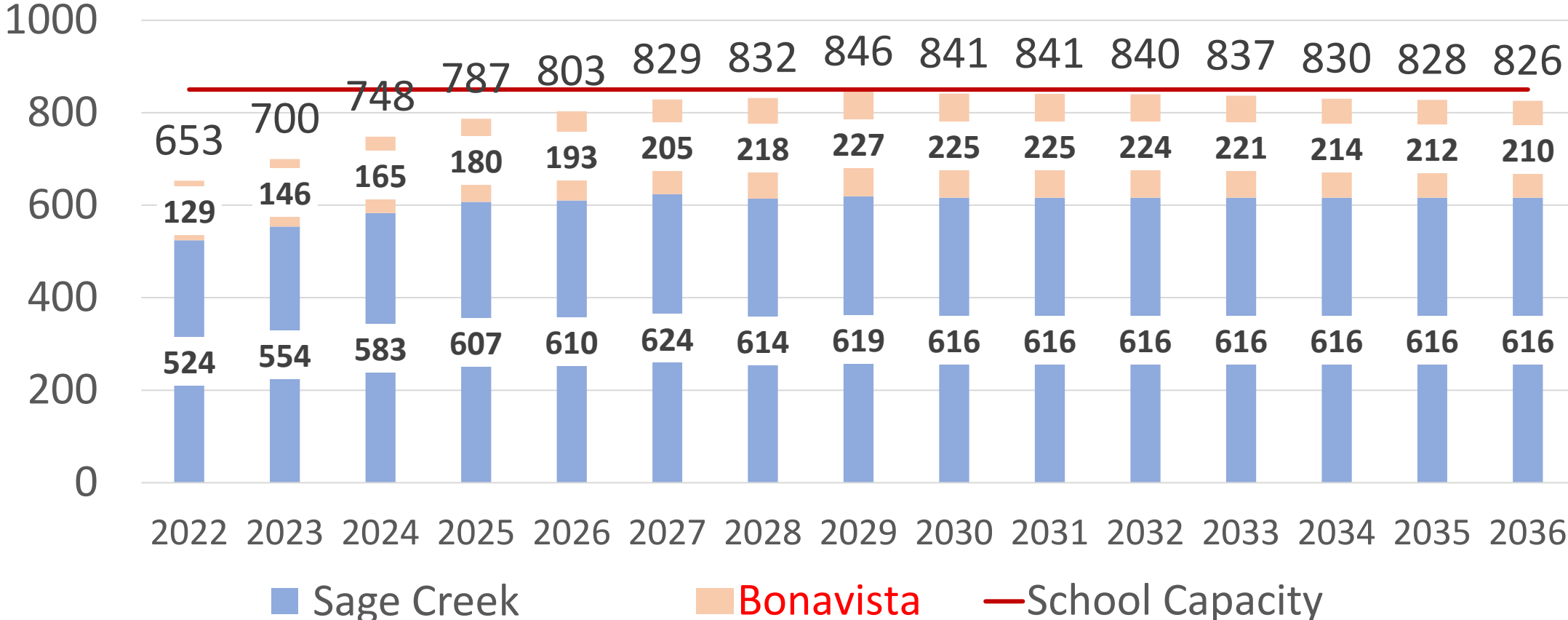

Location of the New School



Existing School

New School

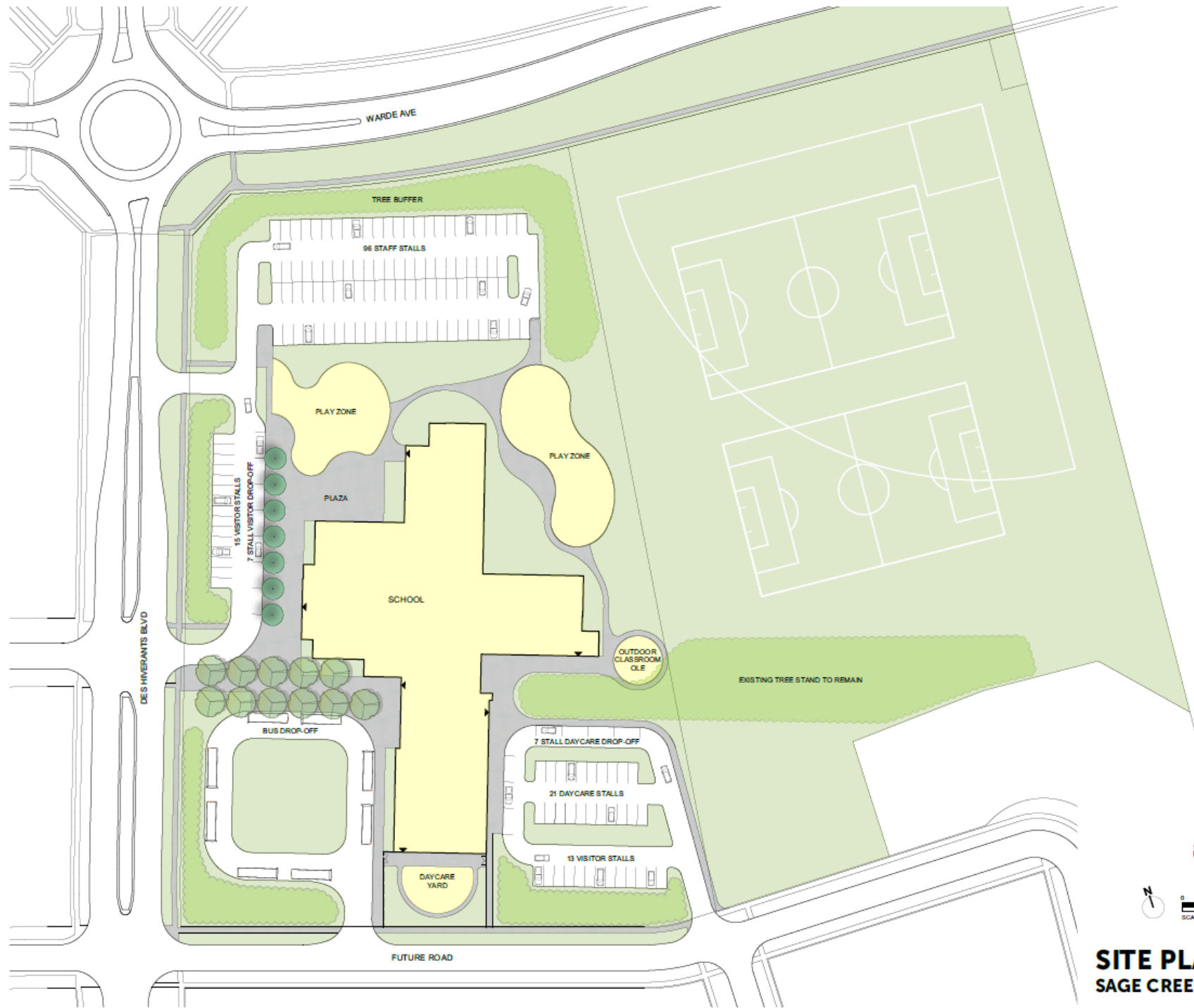

SITE PLAN OPTION 1
SAGE CREEK SCHOOL TEST FIT

2022-03-17

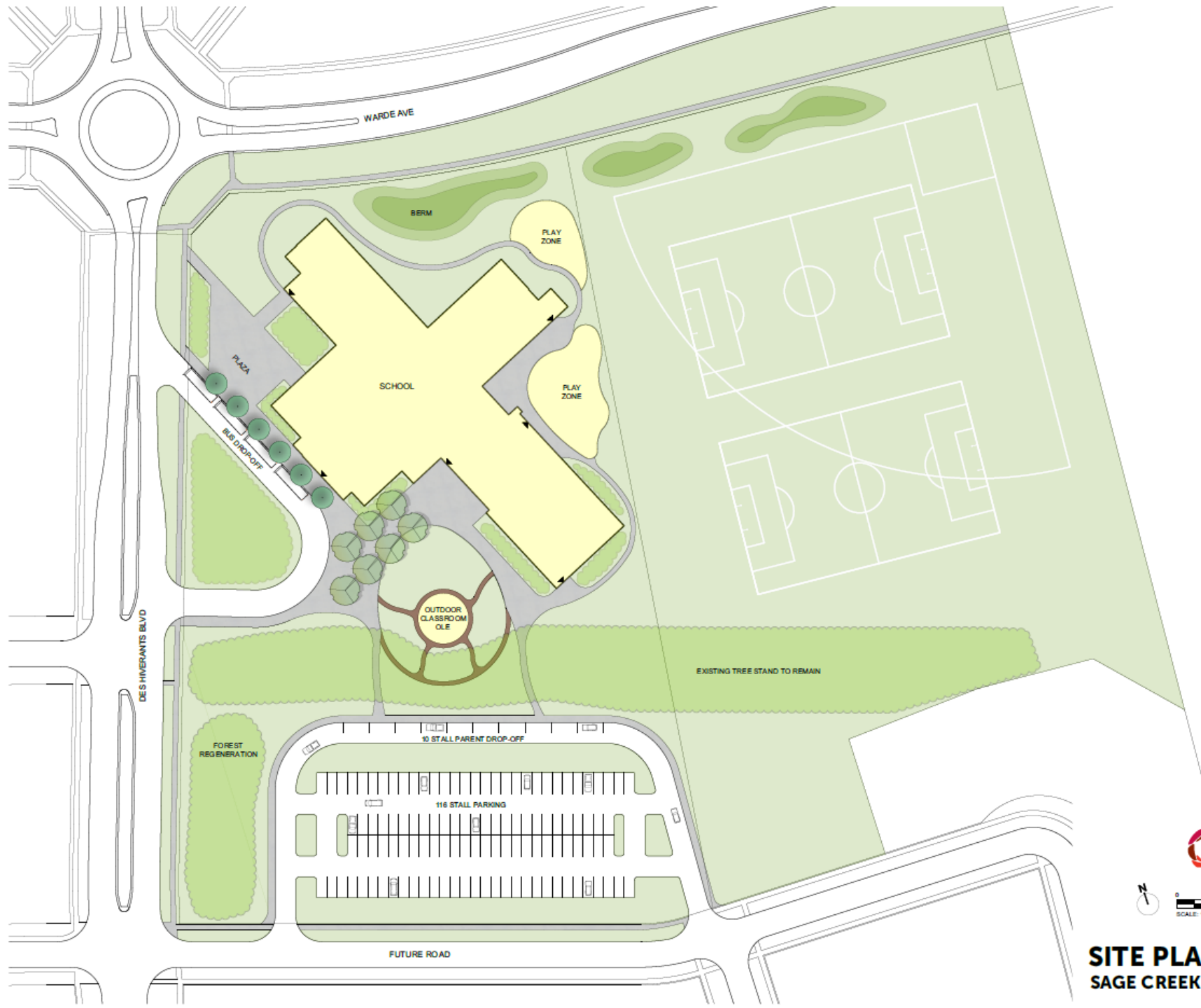

SITE PLAN OPTION 2
SAGE CREEK SCHOOL TEST FIT
2022-03-17

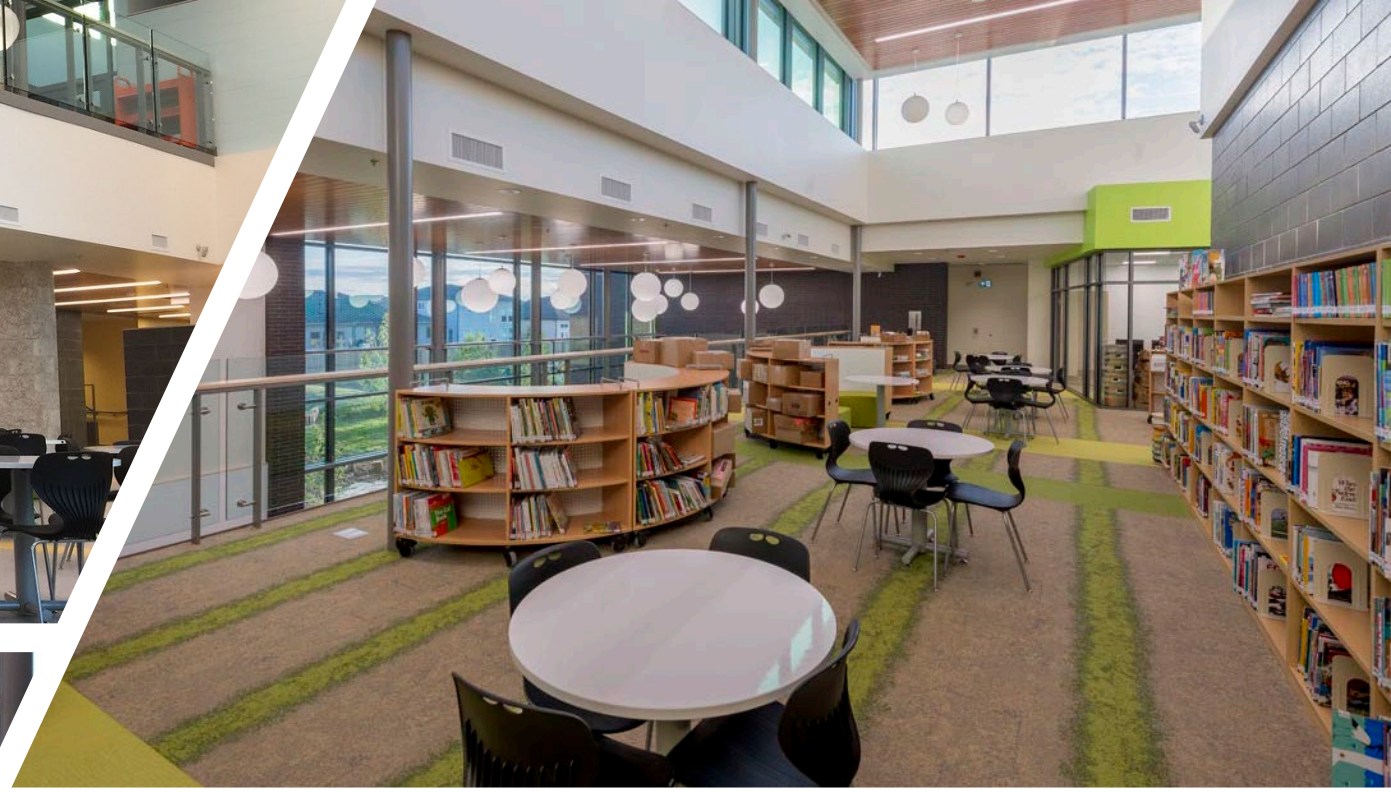



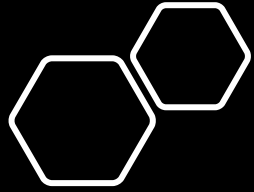

Two Schools in Sage Creek by 2025-2026

French Immersion program students will attend the new school built for 850 students.



Award Magazine

Featured: École Sage Creek School
Date: February, 2017
[Article Link](#)



Award Magazine

Featured: Pikangikum First Nation School
Date: August, 2016
[Article Link](#)

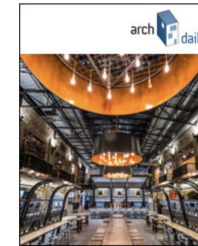

ArchDaily

Featured: The Forks Market Refresh
Date: July, 2016
[Article Link](#)



Award Magazine

Featured: RBC Convention Centre
Date: April, 2016
[Article Link](#)



Canadian Architect

60 Years Edition
Featured: Winnipeg Art Gallery
Date: August, 2015



Award Magazine

Featured: MTS Data Centre
Date: June, 2015
[Article Link](#)



Best Managed

Canada's Best Managed Companies
Featured: Number TEN Architectural Group (winner, 2014)
Date: March, 2015



Architecture (RAIC / IRAC Architecture Canada)

Open to Nature
Featured: Qualico Family Centre + Cover
Date: Summer/Fall 2014



Award Magazine

Featured: Seven Stones Community School
Date: October, 2014
[Article Link](#)

Proud architects of **École Sage Creek School**, opening 2017
Fières architectes de l'École Sage Creek, ouverture prévue en 2017

Visit www.numberten.com to watch our video fly-through

Proud to have provided
Structural Engineering Services
 for the
École Sage Creek

Crosier Kilgour & Partners Ltd.
 CONSULTING STRUCTURAL ENGINEERS
 350-1275 Carlton Street | Winnipeg, MB | R3C 5R6 | T 204.943.7503 | F 204.943.7507 | www.ckp.ca

Spray on Systems
 Polyurethane Foam Specialists

Commercial • Residential
 Industrial • Transportation

We are honoured to have been
 involved in the École Sage Creek
 School project!

204.235.0267
 Winnipeg, MB
info@sprayonsystems.com
www.sprayonsystems.ca

Proud to be the masonry contractors
 at **École Sage Creek School!**

42 Merit Crescent
 West St. Paul MB R2P 2W5
 Ph. 1(204)334-3482 Fax 1(204)334-3623

CUNHA MASONRY INC.

Bockstael
 Manitoba's Builder

Contact us at (204) 233-7135 or visit our website at
www.bockstael.com

General Contractor • Design Builder • Construction Manager

SILEX
 FIBERGLASS
 WINDOWS & DOORS

Congratulations to
Bockstael Construction on
 another successful project!
 We are honoured to be part
 of the **École Sage Creek**
 School project.

1654 Field Street | Winnipeg, MB
 204.788.0648 | www.silexfiberglass.com



LOCATION
 340 Sage Creek Boulevard, Winnipeg, Manitoba

OWNER/DEVELOPER
 Louis Riel School Division /
 Public Schools Finance Board

ARCHITECT
 Number Ten Architectural Group

GENERAL CONTRACTOR
 Bockstael Construction Limited

STRUCTURAL CONSULTANT
 Crosier Kilgour & Partners Ltd.

**MECHANICAL/ELECTRICAL/
 LEED CONSULTANT**
 MWM Group Limited (now WSP Canada)

TOTAL SIZE
 77,000 square feet

TOTAL COST
 \$22.5 million

École Sage Creek School

by PETER STENNING

In the fall of 2015, when construction of the LEED Gold-targeted École Sage Creek School in Winnipeg had just commenced, its soon-to-be principal Marc Poirier remarked, "The look of the school is going to be amazing and far from typical. It's going to be a state-of-the-art school."

Poirier went on to note, "The common areas are going to be great for both teachers and students to extend their classrooms, and to collaborate with other classes. Also, it's not only going to look great, it will answer the needs of kids and teachers to ensure deeper learning. That's the most impressive part for me; not just the look of it, but that it will be a great place to learn."

École Sage Creek is located in an area of wetlands and parks, connected by an inviting network of trails that converge on the Sage Creek community's village centre. The dual track school, with capacity for up to 600 students from Kindergarten to Grade 8 (including a daycare), was designed to celebrate its surroundings by bringing the outdoors in (with the premise that children learn better when engaged and moving). It also features a practical arts classroom, a Makers' Studio, as well as a two-storey learning commons and library.

Number Ten Architectural Group was retained by Louis Riel School Division and the Public Schools Finance Board in September 2013 to create what would become, in terms of structural appearance, an attractive amalgamation of spaces, with varying textures and colours of masonry, glazing and Tyndall stone - all carried into the school's common space to help blur the lines between exterior

and interior, and reflect the natural qualities and colours of the Prairie region. The textures also included a wall imbedded with real fossils. In order to advance the notion of the building itself being a learning tool.

Number Ten associate and education and recreation studio lead Christina Legris and her colleagues developed a design accommodating the 21st-century learning principals that, in architectural terms, downplay the presence of corridors and favour flexibility and integration. "We organized the school into neighbourhoods, with each neighbourhood being five or six classrooms grouped around a common teaching space," Legris explains, adding that the walls of some classrooms were designed to retract so as to create larger collaborative spaces for group lectures or other uses. Floor-to-ceiling, double-height spaces were also developed to impart a sense of scale not commonly found in traditional school design, and help to visually connect the main floor learning commons or library space between classrooms.

Poirier notes that another purpose of École Sage Creek School is to "bring the community together and help people get to know their neighbours." To this end, instead of designing a traditional library, Legris created a main floor learning commons for the general public. "It somewhat resembles a living room, and looking over this space on the second level is the library with media spaces," she says. "It was important to create a welcoming flow, so just beyond the main entrance you have the learning commons with a direct view through the building to the Early Years Outdoor



Learning Lab, and a view of the upstairs library and media spaces, followed by short corridors that lead directly to the different neighbourhoods."

An emphasis on bringing as much natural light into the building resulted not only in a gymnasium whose southeast corner is framed with floor-to-ceiling glazing, but also the unique ability "for anyone, no matter where they are located within the school, to see the exterior surroundings," according to Legris. The school's south wing was designed to have a garage door that, when open during the warm months to the

Makers' Studio Outdoor Lab, provides an indoor/outdoor studio space.

Key to the indoor/outdoor design theme is what Legris describes as "just over five acres of carefully designed landscape, serving as an active playground with bridges, stumps and various flora plantings indigenous to the region." Given the school's reverence for all things natural, the building's extensive exterior glazing was imbedded with a subtle dot pattern to prevent migratory birds from impacting against the glass.

Tyler Smeall, structural engineer at Crosier Kilgour & Partners Ltd.,



École Sage Creek School

EDUCATIONAL AWARD OF EXCELLENCE



ÉCOLE SAGE CREEK SCHOOL

Architect: Number Ten Architectural Group
Location: Winnipeg, MB
Engineer: Crosier Kilgour & Partners Ltd
Masonry: Cunha Masonry Inc
Supplier: Expocrete Concrete Products Ltd; Gillis Quarries Ltd; TimberStone Distribution Ltd
Owner: Louis Riel School Division
General: Bockstael Construction Ltd

DESCRIPTION

The design of École Sage Creek School strives to be respectful to the surrounding context and take inspiration from the local history, materials and community. The school's exterior cladding for both the interior and exterior of the school as a material that was durable, long lasting and aesthetically appealing.



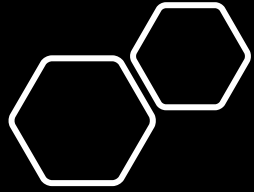

Second School in Sage Creek

French
Immersion
Program



**Grades K-8, 675 students, core capacity
accommodate to 875 students**

Classrooms

Kindergarten Room	4	1,000	4,000
Flex K/Grade 1 classroom	1	1,000	1,000
General Classrooms	31	860	26,660
Science Room	2	1,000	2,000
Art Room	1	1,000	1,000

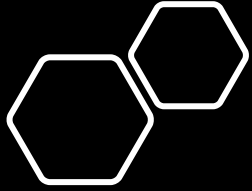

Second School in Sage Creek

French
Immersion
Program

Specialized Educational Spaces

STEM Lab	1	1,000 sq ft
Language Room	2	1,720 sq ft
Life Skills Suite	1	1,200 sq ft
Universal Change/Toilet Room	1	250 sq ft
Music Room	1	1,300 sq ft
Resource teaching/support services	1	1,200 sq ft
Guidance	1	500 sq ft
Multipurpose/Band Room	1	3,000 sq ft
Library / Learning Commons	1	2,400 sq ft
Gymnasium with 24' clearance	1	7,600 sq ft



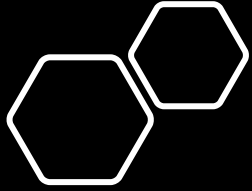

Second School in Sage Creek

French
Immersion
Program

Specialized Educational Spaces

Home Economics	1	1,600 sq ft
Manufacturing/Construction	1	2,400 sq ft
Health Room / Sick Room	1	100 sq ft
Shared Child Care/School Space	2	1,000 sq ft
Kitchenette / Server	1	250 sq ft
Ancillary @65/35		32,943 sq ft
Vertical Circulation Allowance		1,400 sq ft
Dedicated Mechanical and Electrical		3,294 sq ft
74 Child Care Spaces		6,900 sq ft
Total Spaces		105,717 sq ft



Our Journey So Far

TIMELINE	MANITOBA GOVT.	DIVISION	DEVELOPER
December 3, 2020	Authorization Letter for Acquisition of Property – New Sage Creek School		
February 1, 2021		Appraisal of approximately 6.0 Acres of Vacant Development Lands	
February 10, 2021		Phase 1 Environment Site Assessment	
February 25, 2021		Signed Letter of Intent	Signed Letter of Intent
May 2021		Signed Land Purchase Agreement	Signed Land Purchase Agreement
April 2021			Development and Rezoning Application
April 2022			Site Development – in progress
April 2022	Program Data Sheet		
May 2022		Submitted Program Data Sheet	

Next Steps

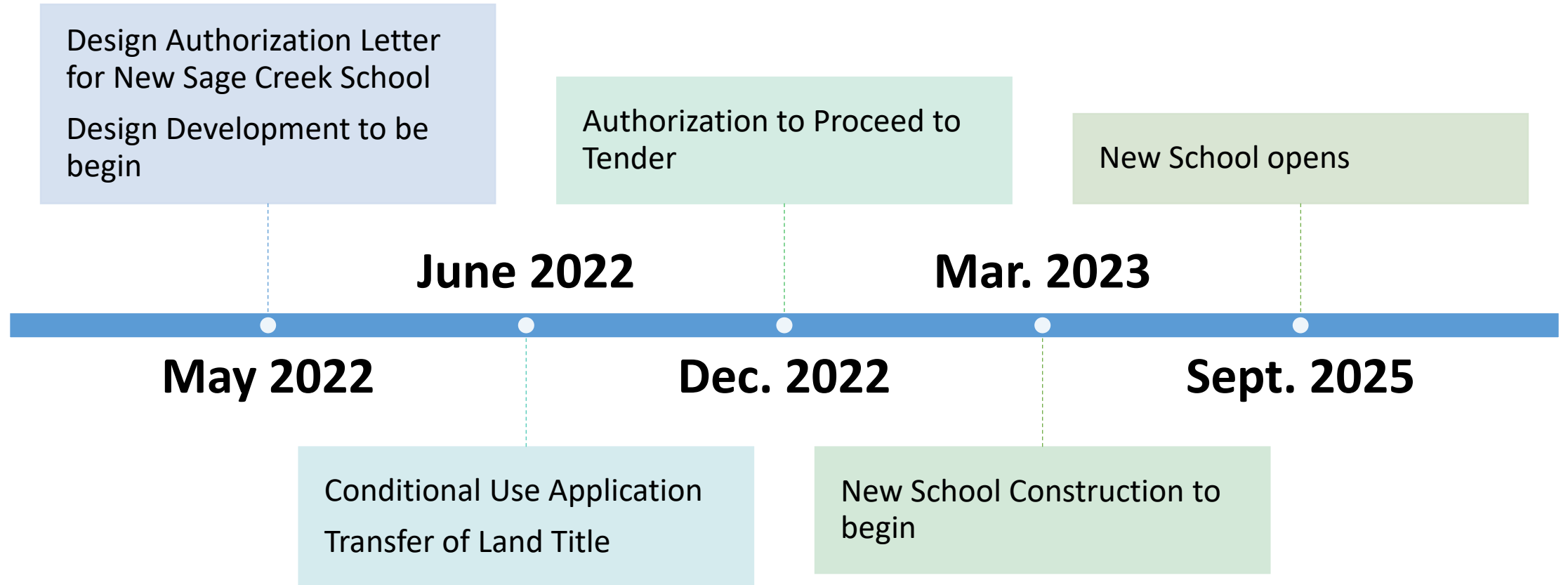

Questions?





Additional
questions or
comments?
Share your
thoughts through
our Exit Survey



END OF PRESENTATION